



Turnpike Lane, N8 0DY

£365,000 LEASEHOLD

Chain free, stylish two double bedroom apartment with a large living room and kitchen diner occupying the second floor of a Victorian building in Turnpike Lane. Perfect for young professionals, first time buyers or as a rental investment.

Features include - A fantastic open plan kitchen living space which provides a functional and social space for a professional couple to entertain. Two bedrooms, a spacious modern bathroom with access to a stunning private roof terrace.

The property is conveniently placed for transport and local amenities, with Hornsey Overground and Turnpike Lane & Underground being close by. Not failing to mention Wood Green Shopping City on your doorstep and affluent districts like Crouch End and Alexandra Palace within walking distance.





Turnpike Lane, N8

Approx. Gross Internal Area 578 Sq Ft - 53.7 Sq M

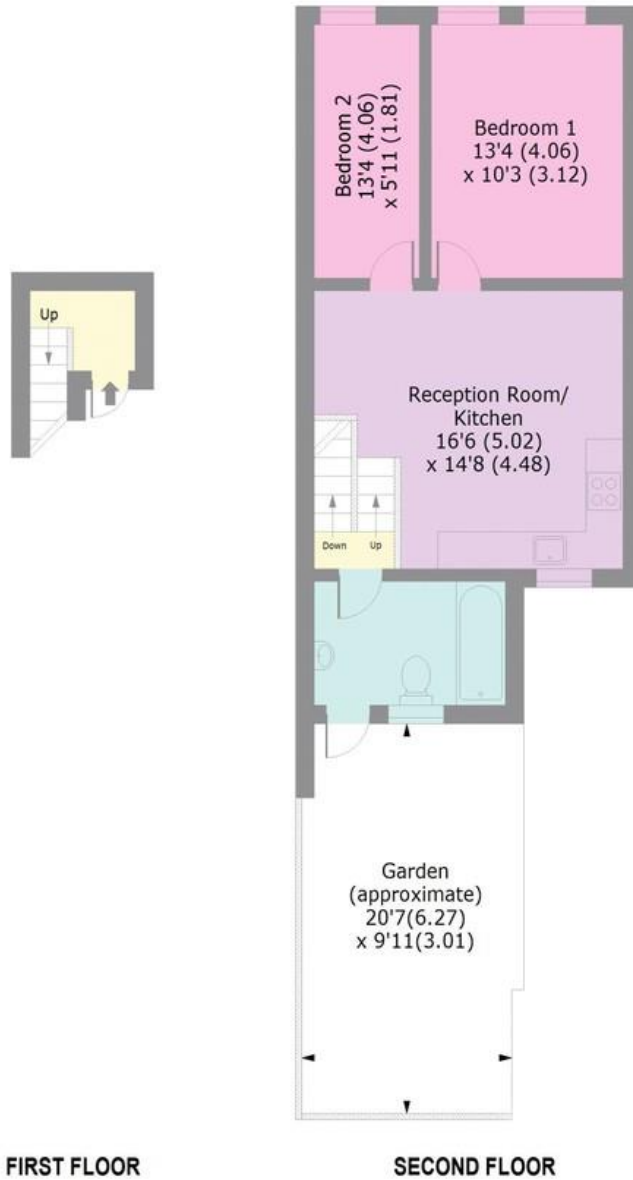



lpaplus.com



2  Bedrooms

1  Receptions

1  Bathrooms

Yes  Roof Terrace

Tenure:
Leasehold

Energy Efficiency Rating:

Energy Efficiency Rating		Current	Potential
Score	Energy rating		
92+	A		
81-91	B		
69-80	C	76 C	79 C
55-68	D		
39-54	E		
21-38	F		
1-20	G		

Bounds Green Office
 3 Latham Court
 Brownlow Road
 London N11 2ES
 0208-365-8900

boundsgreen@wilkinsonbyrne.com

Turnpike Lane Office
 8 Turnpike Parade
 Green Lanes
 London N15 3EA
 0208-888-0022

Turnpikelane@wilkinsonbyrne.com