



Graham Road, N15 3NL

**£650,000 FREEHOLD**

A desirable three bedroom mid-terrace house situated on a desirable tree lined residential road. The ground floor features a spacious bay fronted reception room, stunning kitchen/diner with bi-folds doors to a picturesque rear garden. The first floor boasts three bedrooms, contemporary shower room and access to the loft space. Graham Road is located within catchment area of local primary schools including Belmont Junior school (awarded Ofsted-outstanding, opposite Belmont Recreation Ground) and moments away from Green Lanes, Harringay with its superb selection of shops and restaurants as well as the highly acclaimed Salisbury Arms public house and Blend coffee shop. Transport can be found at Turnpike Lane (Piccadilly Line) Underground station as well as Hornsey Rail station.

**\*\*Chain Free\*\***



**Graham Road, N15**

Approx. Gross Internal Area 775 Sq Ft - 72.0 Sq M

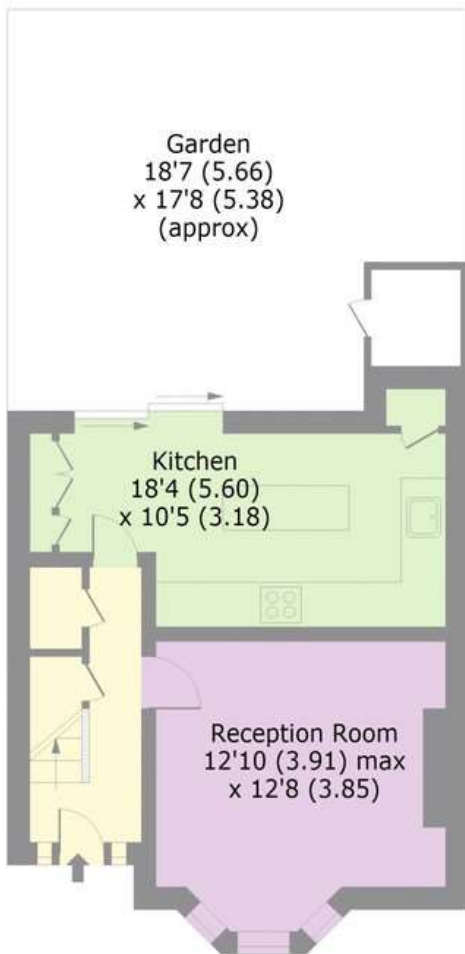

**GROUND FLOOR**





**FIRST FLOOR**

lpaplus.com



3  Bedrooms

1  Receptions

1  Bathrooms

Yes  Garden

**Tenure:**  
Freehold

**Energy Efficiency Rating:**  
70

**Bounds Green Office**  
3 Latham Court  
Brownlow Road  
London N11 2ES  
0208-365-8900

**Turnpike Lane Office**  
8 Turnpike Parade  
Green Lanes  
London N15 3EA  
0208-888-0022

[boundsgreen@wilkinsonbyrne.com](mailto:boundsgreen@wilkinsonbyrne.com)

[Turnpikelane@wilkinsonbyrne.com](mailto:Turnpikelane@wilkinsonbyrne.com)