



Alice Court, N22 5RH

**£350,000 SHARE OF FREEHOLD**

A desirable two bedroom apartment in a well maintained private purpose built block with stunning views of the green open spaces of White Hart Lane Recreation ground. The property has been well maintained by the current owner and is perfect for a first time buyer. Benefits include a spacious open plan reception/kitchen with integrated appliances, two double bedrooms and modern bathroom. Douglas Road is ideally situated for the vibrant Wood Green shopping area with all its bars and restaurants and with easy access to both Wood Green and Turnpike Lane Underground station.

**\*\*Chain Free\*\***



**Alice Court, Doughes Road, NZ2**

Approx. Gross Internal Area 594 Sq Ft - 55.2 Sq M

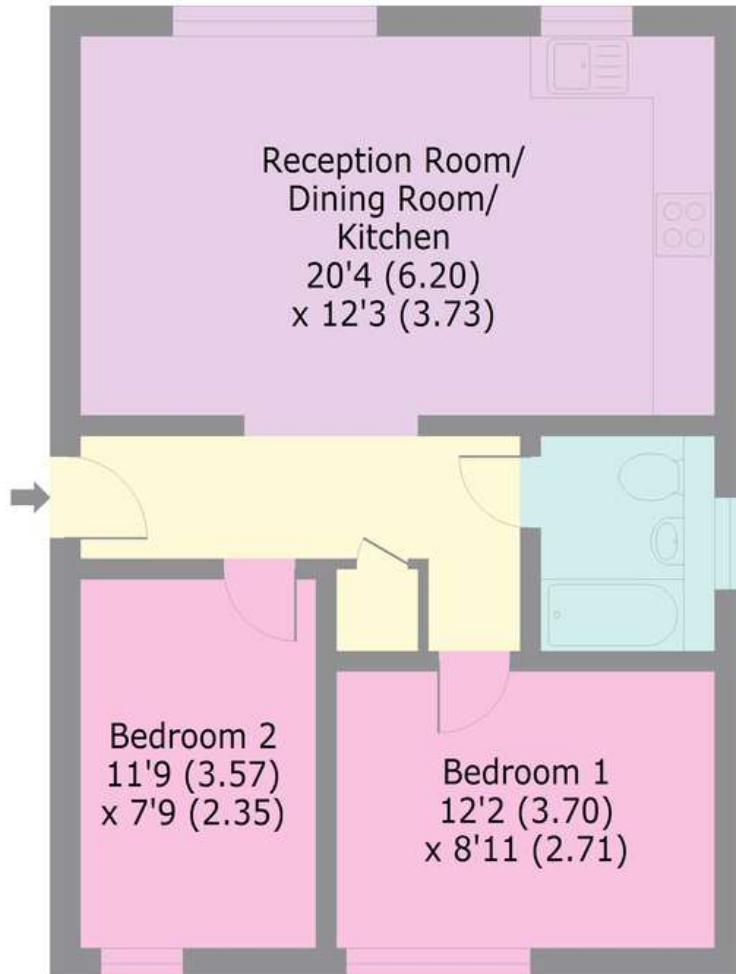



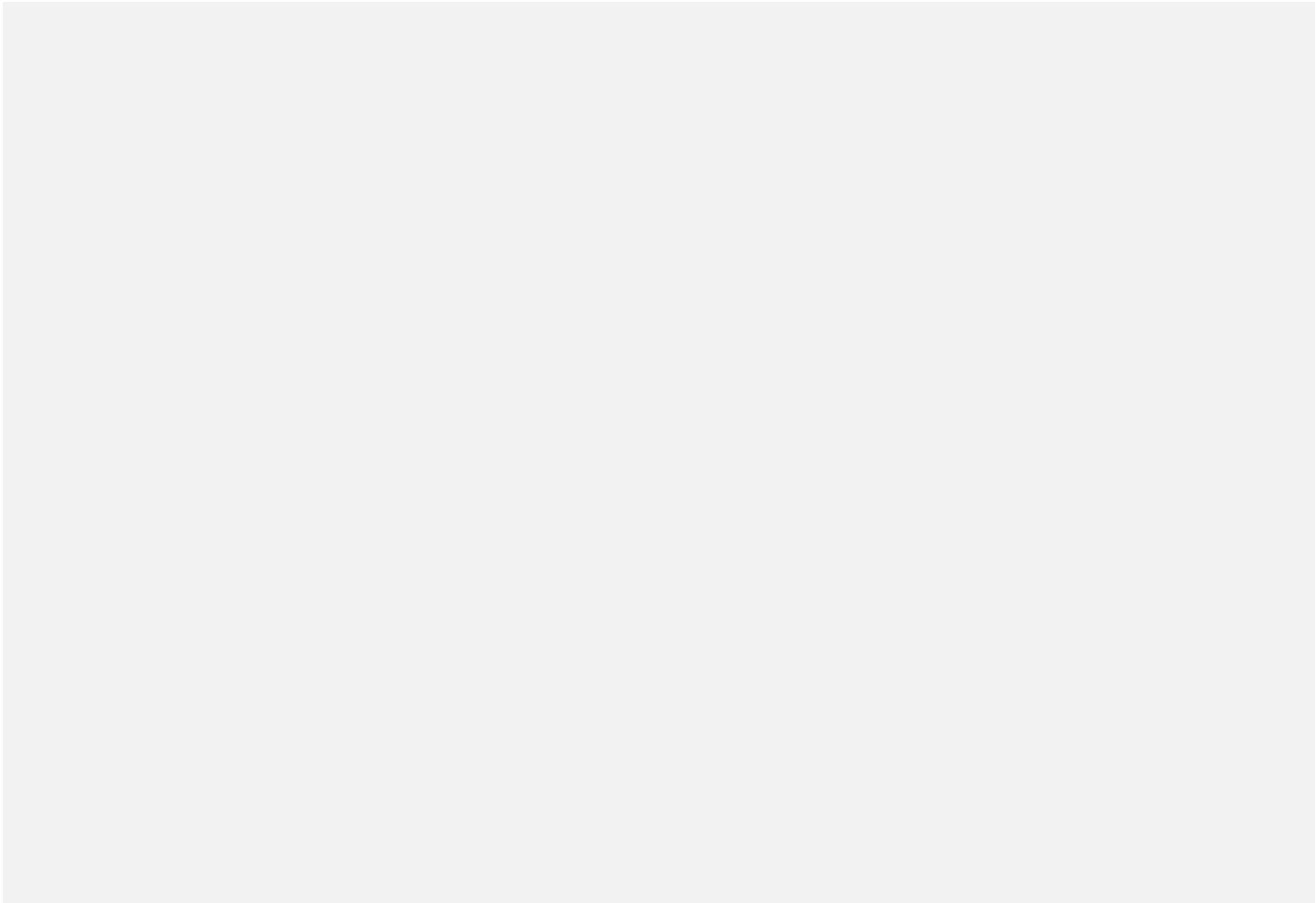

**FIRST FLOOR**

lpaplus.com





|    |   |            |
|----|---|------------|
| 2  |  | Bedrooms   |
| 1  |  | Receptions |
| 1  |  | Bathrooms  |
| No |  | Garden     |

**Tenure:**  
Share of Freehold

**Energy Efficiency Rating:**  
82

**Bounds Green Office**  
3 Latham Court  
Brownlow Road  
London N11 2ES  
  
0208-365-8900

**Turnpike Lane Office**  
8 Turnpike Parade  
Green Lanes  
London N15 3EA  
  
0208-888-0022

[boundsgreen@wilkinsonbyrne.com](mailto:boundsgreen@wilkinsonbyrne.com)

[Turnpikelane@wilkinsonbyrne.com](mailto:Turnpikelane@wilkinsonbyrne.com)