

Apple Tree Road, N17

GUIDE PRICE £315,000 - £330,000

LEASEHOLD

THIS PROPERTY IS CURRENTLY SUITABLE ONLY FOR FIRST TIME BUYERS WHO CURRENTLY LIVE OR WORK IN HARINGEY, DO NOT OWN ANOTHER PROPERTY AND HAVE A HOUSEHOLD INCOME BELOW £68,037.

This exciting new urban development of design-led homes stands behind acres of parkland yet is still close to the heart of London. A great opportunity for first time buyers to live in a beautifully crafted home alongside expansive green spaces.

This one bedroom-apartment is situated on the top floor (fourth) of this modern purpose-built block. It is flooded with natural light and presented in excellent decorative condition.

The apartment consists of a spacious open plan modern kitchen diner with integrated appliances, a double bedroom with floor to ceiling fitted wardrobe, modern bathroom and a storage cupboard/utility space. The building also benefits from a stunning communal roof terrace offering magnificent views of the surrounding area.

Further benefits include communal allotments and bike storage.

The apartment is located on a broad tree-lined avenue and is a short walk away from the open spaces of Downhills Park and trendy Green Lanes N4. The area has attracted more and more independent food and drink establishments, such as highly acclaimed True Craft Tap House, Blighty India Café, Forks & Green & Perkyn's that serves fresh coffee and craft beer.

Transport can be found at Turnpike Lane (Piccadilly Line) & Seven Sisters (Victoria Line) Underground station. There are also great links to the Overground & Railway stations – Seven Sisters, Bruce Grove and White Hart Lane.

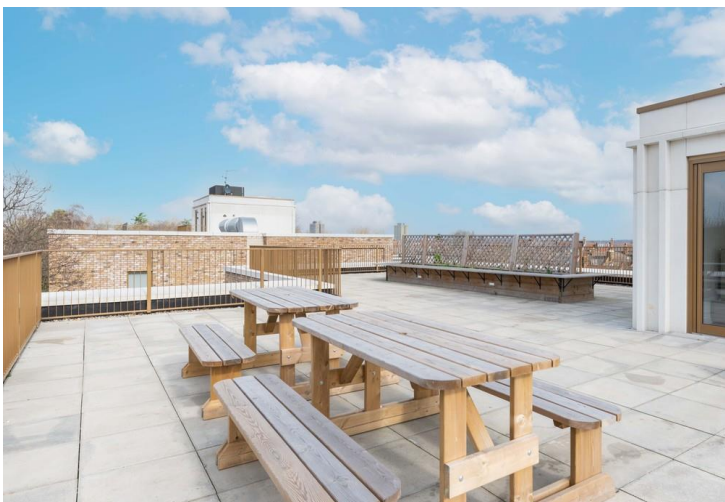

Opal House, N17

Approx. Gross Internal Area 411 Sq Ft - 38.21 Sq M

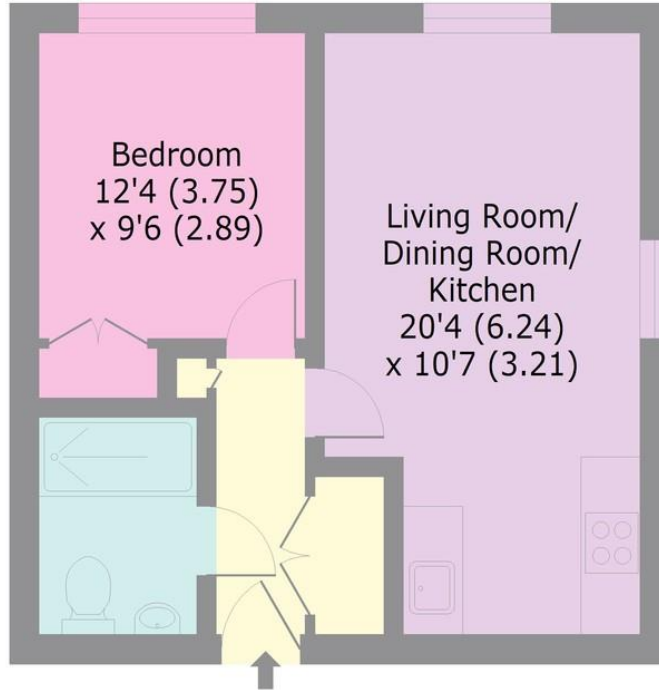
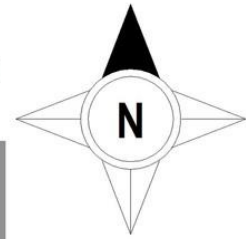

FOURTH FLOOR

lpaplus.com



1



Bedroom

1



Reception

1



Bathroom

No

Garden

Tenure:
Leasehold

Energy Efficiency Rating:
83

Bounds Green Office
3 Latham Court
Brownlow Road
London N11 2ES
0208-365-8900

Turnpike Lane Office
8 Turnpike Parade
Green Lanes
London N15 3EA
0208-888-0022

boundsgreen@wilkinsonbyrne.com

Turnpikelane@wilkinsonbyrne.com