



## Langham Close, N15 3LD

**A GUIDE PRICE OF £300,000 - £325,000**

A beautifully presented one bedroom ground floor apartment set in a well maintained gated purpose built block on a popular turning, a stone throw away from Turnpike Lane Station. Benefits include a reception room and dine-in kitchen, perfect for entertaining, contemporary bathroom, one double bedroom overlooking the stunning communal gardens which will be perfect for you to enjoy with friends and family in the summer months. Langham Close is ideally situated for the vibrant Wood Green shopping area with all its bars and restaurants and with easy access to Turnpike Lane and Wood Green Underground Station (Piccadilly Line) and multiple bus routes. The iconic Westbury Gastro Pub and Restaurant (Westbury Avenue) as well as the green open spaces of Belmont Park with access to both Lordship Recreation grounds and Downhill's Park are all close by.



## Langham Close N15

Approx. Gross Internal Area 417 Sq Ft - 38.7 Sq M

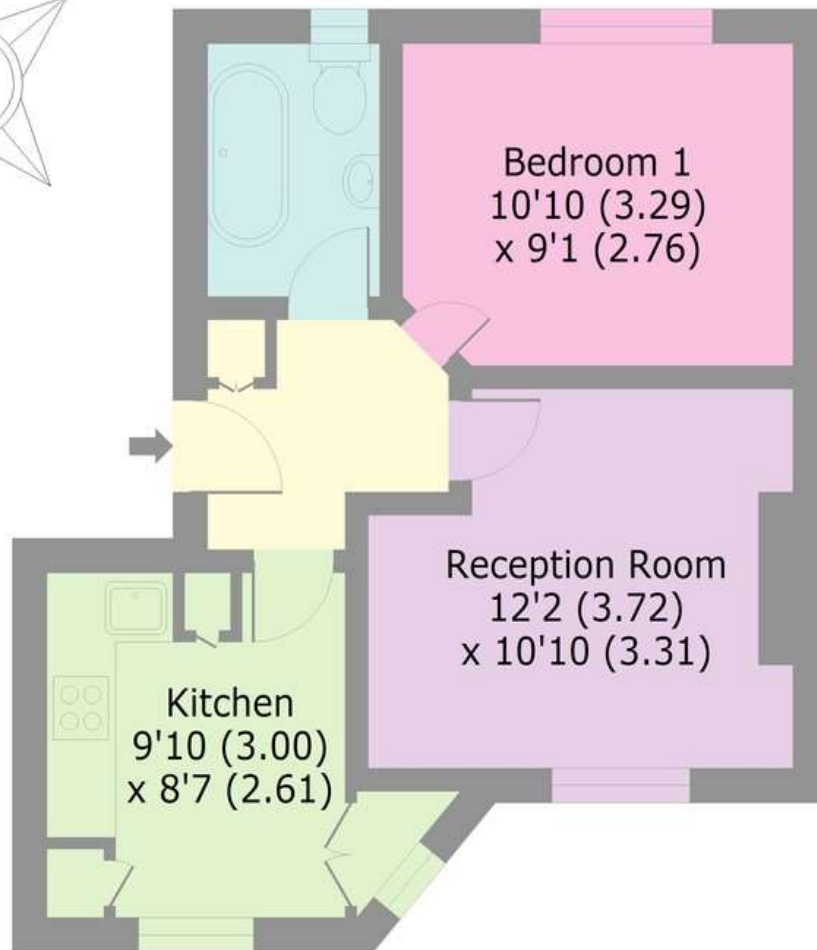

**GROUND FLOOR**



1



Bedrooms

1



Receptions

1



Bathrooms

Yes



Communal Garden

**Tenure:**  
Leasehold

**Energy Efficiency Rating:**  
71

**Bounds Green Office**  
3 Latham Court  
Brownlow Road  
London N11 2ES  
0208-365-8900

**Turnpike Lane Office**  
8 Turnpike Parade  
Green Lanes  
London N15 3EA  
0208-888-0022

[boundsgreen@wilkinsonbyrne.com](mailto:boundsgreen@wilkinsonbyrne.com)

[Turnpikelane@wilkinsonbyrne.com](mailto:Turnpikelane@wilkinsonbyrne.com)