



Burghley Road, N8 0QG

£1,550 pcm

A stunning two bedroom ground floor conversion located on a desirable tree residential road. The property has tastefully decorated by the current landlord and is perfect for a couple or professional sharers. Benefits include a spacious reception room with access to a private rear garden, contemporary kitchen, two double bedrooms and a modern bathroom. Transport and local amenities are excellent, with Hornsey Overground and Turnpike Lane & Wood Green Underground being close by. A wide variety of restaurants and retail offerings are within a short walk. Trendy Green Lanes and Crouch End are all also within walking distance, as well a variety of excellent local parks including Downhills Park, Priory Park and Alexandra Palace.

****Available Now****



Burghley Road, N8

Approx. Gross Internal Area 636 Sq Ft - 59.1 Sq M

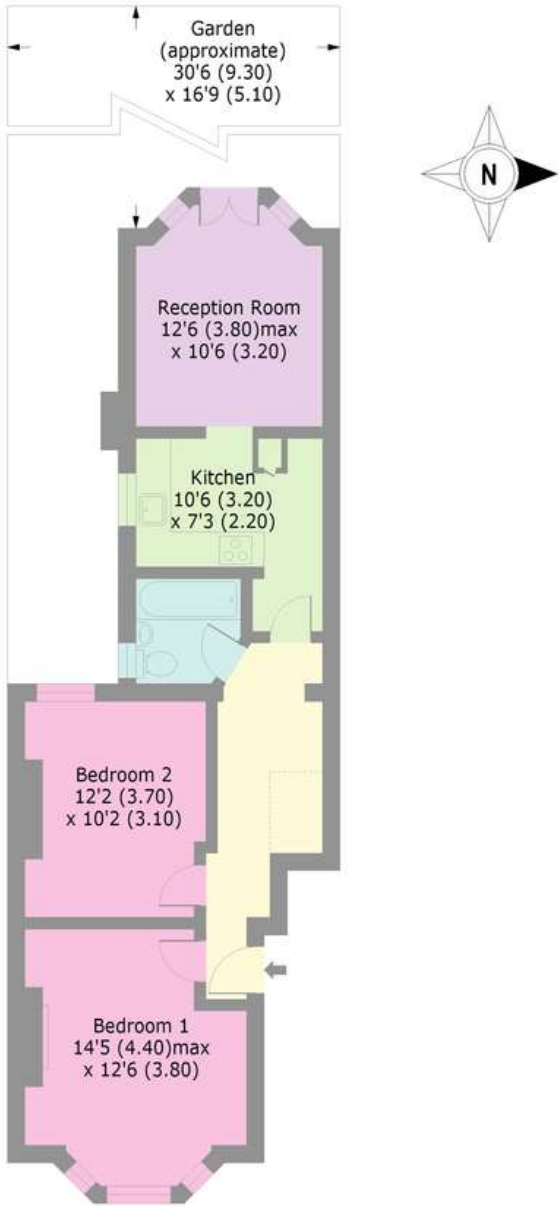

GROUND FLOOR



2



Bedrooms

1

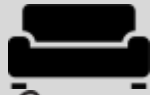

Receptions

1



Bathrooms

Yes



Garden

Energy Efficiency Rating:

64

Bounds Green Office

**3 Latham Court
Brownlow Road
London N11 2ES**

0208-365-8900

boundsgreen@wilkinsonbyrne.com

Turnpike Lane Office

**8 Turnpike Parade
Green Lanes
London N15 3EA**

0208-888-0022

Turnpikelane@wilkinsonbyrne.com