



Darwin Road, N22 6NS

**£550,000 FREEHOLD**

Chain Free. A desirable two-bedroom terraced house which has undergone a complete redesign, located on a sought after tree lined residential road in the popular Noel Park Estate. The current owner has recently refurbished the property to a very high standard, offering a stylish & modern living space. The ground floor features a through lounge, a stunning extended kitchen with real wood worktops, butler sink, under counter lighting integrated appliances & underfloor heating with access to a low maintenance rear garden. The ground floor also benefits from a downstairs cloakroom & a feature lit wall. Upstairs are the two bedrooms along with fully tiled bathroom.





# Darwin Road, N22

Approx. Gross Internal Area 775 Sq Ft - 72.0 Sq M

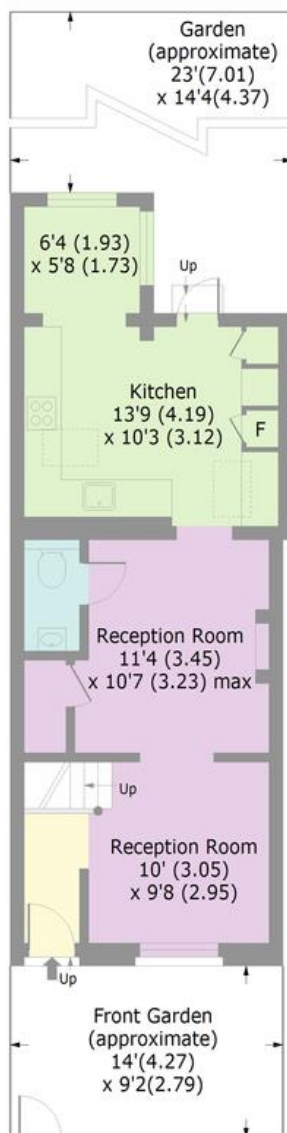

GROUND FLOOR



FIRST FLOOR





2



Bedrooms

1



Reception

1



Bathroom

Yes



Garden

**Tenure:**  
Freehold

**Energy Efficiency Rating:**  
72

**Bounds Green Office**  
3 Latham Court  
Brownlow Road  
London N11 2ES  
  
0208-365-8900

[boundsgreen@wilkinsonbyrne.com](mailto:boundsgreen@wilkinsonbyrne.com)

**Turnpike Lane Office**  
8 Turnpike Parade  
Green Lanes  
London N15 3EA  
  
0208-888-0022

[Turnpikelane@wilkinsonbyrne.com](mailto:Turnpikelane@wilkinsonbyrne.com)