

# WILKINSON **BYRNE**

ESTATE AGENTS



Boundary Road, N22 6AS

**£525,000 LEASEHOLD**

A striking two-bedroom ground floor apartment, situated on one of the more desirable roads in the area. The property has been tastefully decorated by the current vendor with benefits including, a beautiful extended kitchen/diner with a feature skylight window. Benefits include a bay fronted reception room, two double bedroom, contemporary bathroom and kitchen/diner with access to a picturesque rear garden. Boundary Road is ideally situated for the vibrant Wood Green shopping area with all its bars and restaurants and with easy access to Turnpike Lane and Wood Green Underground Station and multiple bus routes. The iconic Westbury Gastro Pub and Restaurant (Westbury Avenue) as well as the green open spaces of both Lordship Recreation grounds and Downhill's Park are all close by.





**Boundary Road, N15**

Approx. Gross Internal Area 748 Sq Ft - 69.5 Sq M

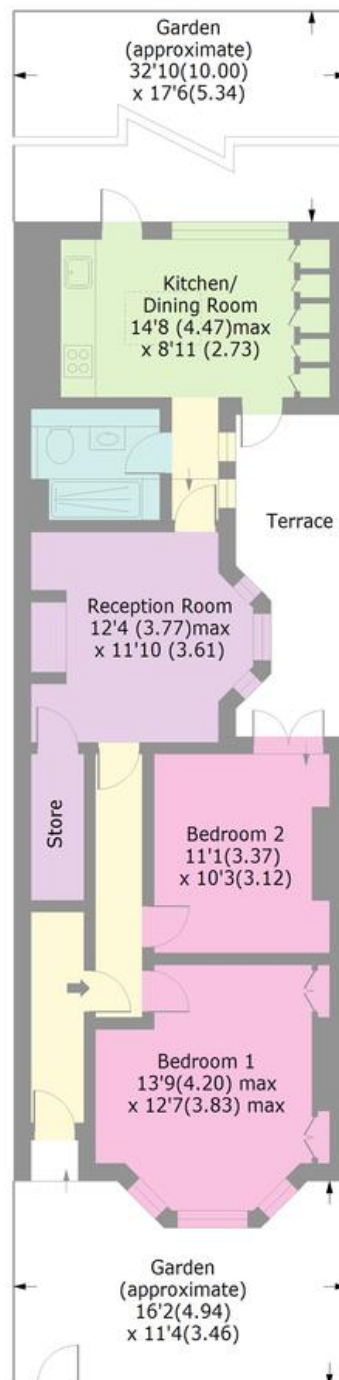

**GROUND FLOOR**





2



Bedrooms

1



Receptions

1



Bathrooms

Yes



Garden

**Tenure:**  
Leasehold

**Energy Efficiency Rating:**  
57

**Bounds Green Office**  
3 Latham Court  
Brownlow Road  
London N11 2ES  
  
0208-365-8900

[boundsgreen@wilkinsonbyrne.com](mailto:boundsgreen@wilkinsonbyrne.com)

**Turnpike Lane Office**  
8 Turnpike Parade  
Green Lanes  
London N15 3EA  
  
0208-888-0022

[Turnpikelane@wilkinsonbyrne.com](mailto:Turnpikelane@wilkinsonbyrne.com)